

Features

- Support HDMI 1.3
- Support 7.1ch
- Support analog stereo 2ch embedder
- One SDI compliant output
- Supported resolutions

3G-SDI Output	
1080p @ 50/ 59.94 / 60Hz	SMPTE 424M, SMPTE 425M
HD-SDI Output	
720p @ 50Hz	SMPTE 296M -3
720p @ 60 / 59.94Hz	SMPTE 296M -1, -2
1080i @ 50Hz	SMPTE 274M -6
1080i @ 60 / 59.94Hz	SMPTE 274M -4, -5
1080p @ 24 / 23.98Hz	SMPTE 274M -10, -11
1080p @ 25Hz	SMPTE 274M -9
1080p @ 30 / 29.97Hz	SMPTE 274M -7, -8
SD-SDI Output	
NTSC	
PAL B,D,G,H,I	

Package contents

- HDMI to 3G/HD/SD-SDI Mini Converter
- Power adapter DC 5V/2A
- Ear mount kit
- Quick Start Guide

Layout

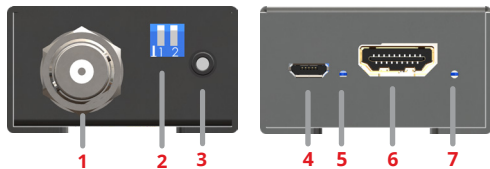

1. SDI OUT: 3G/HD/SD-SDI loop-put
2. Dip Switch: Turn On/Off audio Embedder
3. Audio In: Stereo Embedder in
4. Micro USB Power Input: DC 5V/2A
5. Power LED indicator
6. HDMI IN
7. Signal LED indicator



Position	If setting	
PIN#1	OFF[↑]	Disable Audio Embedder
	ON[↓]	Enable Audio Embedder (Only 2ch output)
PIN#2	OFF[↑]	Reserved
	ON[↓]	Reserved

Application

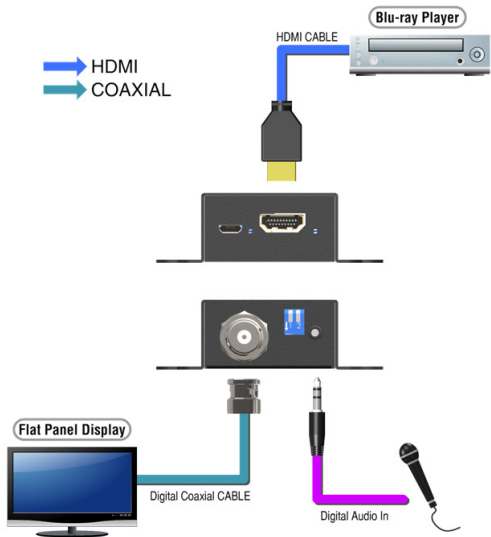

ACEPRO_{AV}

HDMI to 3G/HD/SD-SDI with Audio Embedder Mini Converter

Quick Start Guide

