

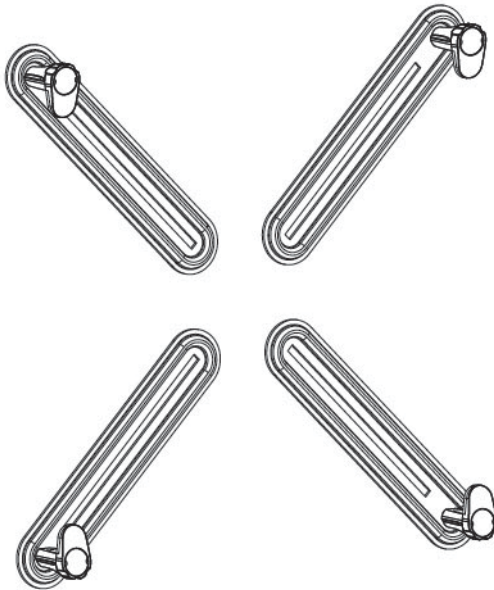

Non-VESA Monitor Adapter Kit for 13" to 27" LCD/LED Screen Sizes

Installation Instructions



Weight Capacity: 8KG (17.6 lbs)

Specifications

| | |
|-------------------|---------------------|
| Screen Size | 13" to 27" |
| Rated Load | 17.6 lbs (8 Kgs) |
| VESA compatible | 75x75 / 100x100mm |
| Screens Thickness | 1" to 1.79" |
| Material | Steel/Plastic |
| Color | Black |
| Product Weight | 1.5 lbs |
| Product Dimension | 14.78"x14.78"x1.57" |

Unpacking

- Carefully remove the contents and lay them out on cardboard or other protective surface
- Check package contents against the parts list to ensure that all components were received undamaged. Do not use damaged or defective parts
- Carefully read all instructions before attempting the installation

Safety Information

- Use proper safety equipment during installation
- If you don't understand the installation instructions, please consult an installation specialist
- This product contains small parts which can act as a choking hazard if swallowed
- Do not use this product for any purpose or in any configuration not explicitly specified in these instructions

Tools Required

- Phillips Screwdriver



A - (4x) Arm



B - (4x) Support



C - (4x) Plastic Cap



D - (8x) Nut



E - (8x) Bolt



F - (4x) M6x40 Bolt



G - (4x) M6x60 Bolt



H - (4x) M6x80 Bolt



I - (8x) Washer



J - (1x) Wrench

Installation

Step 1) Assemble the Support Arm

1. Select **Bolt (F/G/H)** according to the depth of your monitor and use it to install **Support (B)** onto **Arm (A)** using a Phillips screwdriver. Do not fully tighten until instructed to do so, see Figure 1.

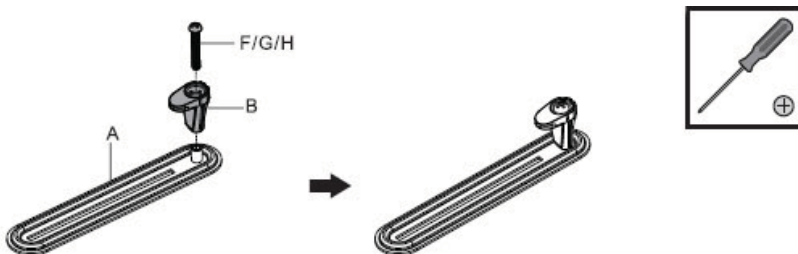

Figure 1

Step 2) Install the Support Arm to the VESA Plate

Note: Select one of the four the installation options that matches your monitor's backplate surface.

- 2A) *X-pattern*: Suitable for all backplate surfaces. Use two sets of bolt/washer/nut to attach each arm to the VESA plate.

1. Use Bolt (E), Washer (I) with Nut (D) and tighten using Wrench (J), see Figure 2. **Note:** Do not fully tighten until instructed to do so in Step 3.

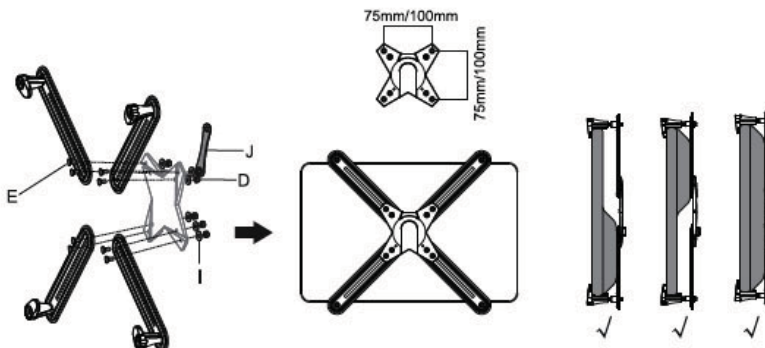

Figure 2

2B) *Y-pattern*: Suitable for all backplate surfaces. Use two sets of bolt/washer/nut to attach the upper arms and one set of bolt/washer/nut to attach the lower arms to the VESA plate.

1. Use Bolt (E), Washer (I) with Nut (D) and tighten using Wrench (J), see Figure 3. **Note:** Do not fully tighten until instructed to do so in Step 3.

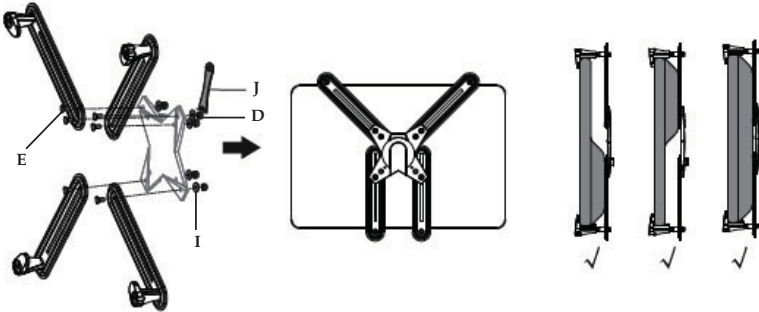

Figure 3

2C) *Inverted Y-pattern*: Suitable for flat and top backplate surfaces. Use two sets of bolt/washer/nut to attach the lower arms and one set of bolt/washer/nut to attach the upper arms to the VESA plate.

1. Use Bolt (E), Washer (I) with Nut (D) and tighten using Wrench (J), see Figure 4. **Note:** Do not fully tighten until instructed to do so in Step 3.

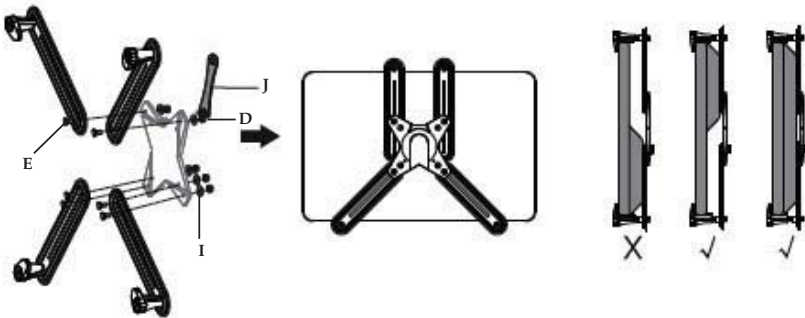

Figure 4

2D) H-pattern: Suitable for flat backplate surfaces. Use one set of bolt/washer/nut to attach the arms to the VESA plate.

1. Use Bolt (E), Washer (I) with Nut (D) and tighten using Wrench (J), see Figure 5. **Note:** Do not fully tighten until instructed to do so in Step 3.

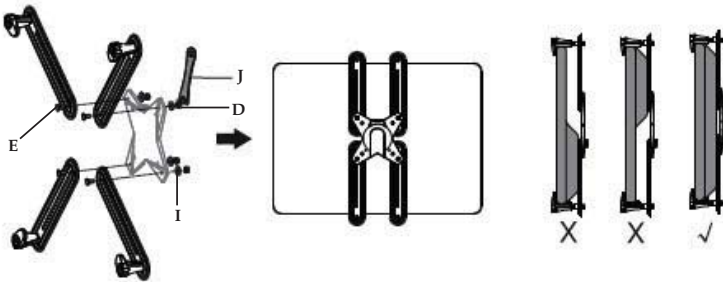

Figure 5

Step 3) Install the Monitor

1. Adjust the position of the Support Arms to match your monitor, then fully tighten Nut (D) using Wrench (J) to secure them to the VESA plate, see Figure 2, 3, 4 or 5.
2. Tighten Bolt (F/G/H) finger tight using a Phillips screwdriver to secure Support (B) to the monitor, see Figure 6.
3. Install Plastic Cap (C) onto Support (B), see Figure 6.

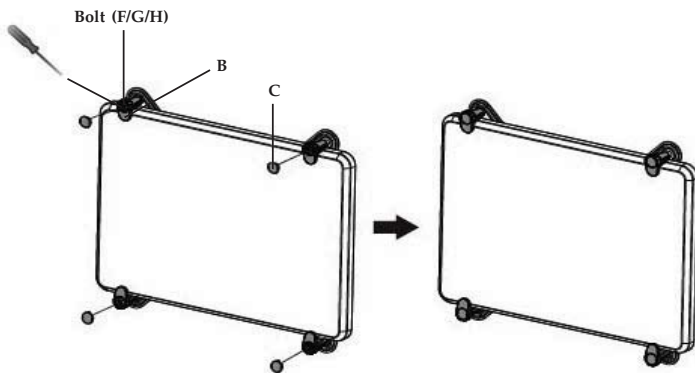

Figure 6

Maintenance

Check the mounting screws every month for tightness.

Blank page

Blank page

Warranty Statement

This warranty covers the original purchaser and guarantees the product to be free of any defects in materials or workmanship for one (1) year from the date of purchase of the product.

Copyright Statement

Non-VESA Monitor Adapter Kit for 13-27" LCD/LED Screen Sizes is a trademark of AVLT-Power Inc. All other trademarks are the property of their respective owners.

Lot Number

Please keep this LOT number for future product return, warranty or exchange.

| |
|--|
| |
|--|

Lot Number

Part Number