



**HDMI 2.0 to DisplayPort 1.2
Converter - 4Kx2K 60Hz
User Reference Guide**



Introduction

The HDMI 2.0 to DisplayPort 1.2 Converter easily connects your HDMI source device to a DP monitor.

Key Features and Benefits

- Supports high resolutions up to 3840x2160@60Hz (4:4:4 8bit) and stereo or coaxial audio (up to 7.1ch) output
- Compliant with DisplayPort 1.2a, HDMI 2.0a and HDCP 2.2
- Built-in EDID management switches allow for expanded compatibility with different monitors
- Sturdy metal housing extends durability and improves heat dissipation

Specifications

Video Bandwidth (Input)	Single-link 600MHz (6.0Gbps)
Video Support	Up to 4Kx2K @60Hz (4:4:4 8bit)
Audio Support	Audio extraction only
HDMI Audio Format	PCM2/5.1/7.1, Dolby 5.1/7.1, DTS 5.1/7.1
Connectors	1x 19-Pin, HDMI, Type A, Female, Input 1x 20-pin, DisplayPort, Female, Output 1x Coaxial, Output 1x 3.5mm Audio Jack, Output
Housing Material	Metal
Power Adapter	Input: AC 100-240V/ 50~60Hz Output: DC 5V / 2A

Package Contents

- HDMI 2.0 to DisplayPort 1.2 Converter - 4Kx2K 60Hz
- Power Adapter
- Mounting Kit
- User Reference Guide

Layout

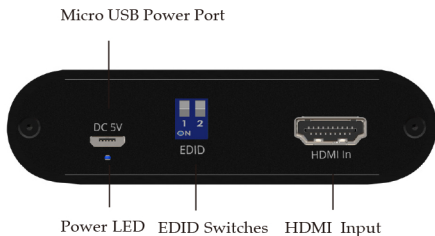

Figure 1: Front side

- **Micro USB Power Port:** Connects to the included power adapter
***Note:** Also used for firmware update. Connect it to the computer by Micro USB cable (cable not included) as needed
- **Power LED:** On when the unit is powered on

- **EDID Switches:** Refer to the table to configure EDID on Page 5
- **HDMI Input:** Connects to HDMI source device by HDMI cable (cable not included)

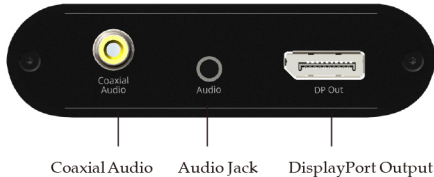

Figure 2: Rear side

- **Coaxial Audio:** Up to 7.1ch surround output - connects to audio output device by coaxial cable (cable not included)
 - **Audio Jack:** Stereo output - connects to audio output device by 3.5mm audio cable (cable not included)
 - **DisplayPort Output:** Connects to a DisplayPort monitor / display by DisplayPort cable (cable not included)
- * **Note:** DisplayPort output has no audio stream

EDID Setting

There are 4 settings.

- "1": The button on the upper position

- "0": The button on the lower position

Switch Position		Description
Pin 1	Pin 2	
1	1	3840x2160 60Hz (Default EDID)
0	1	4096x2160 60Hz
1	0	3840x2160 30Hz
0	0	1080p 60Hz

Application

The *HDMI 2.0 to DisplayPort 1.2 Converter* allows you to connect your HDMI source device to a DP monitor instantly and supports high resolutions up to 4Kx2K.

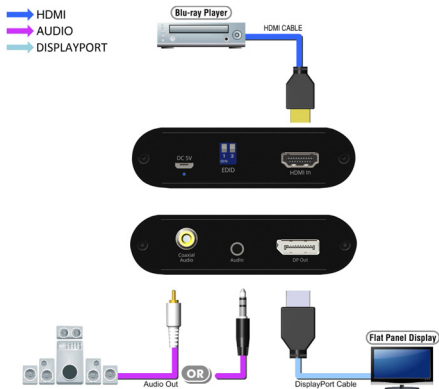

Figure 3

*** Note:**

1. DisplayPort output has no audio stream.
2. For audio output, connect to 3.5mm audio jack (stereo) or coaxial port (up to 7.1ch) depending on your needs.